

KALANBI

Hundred of Goode

6

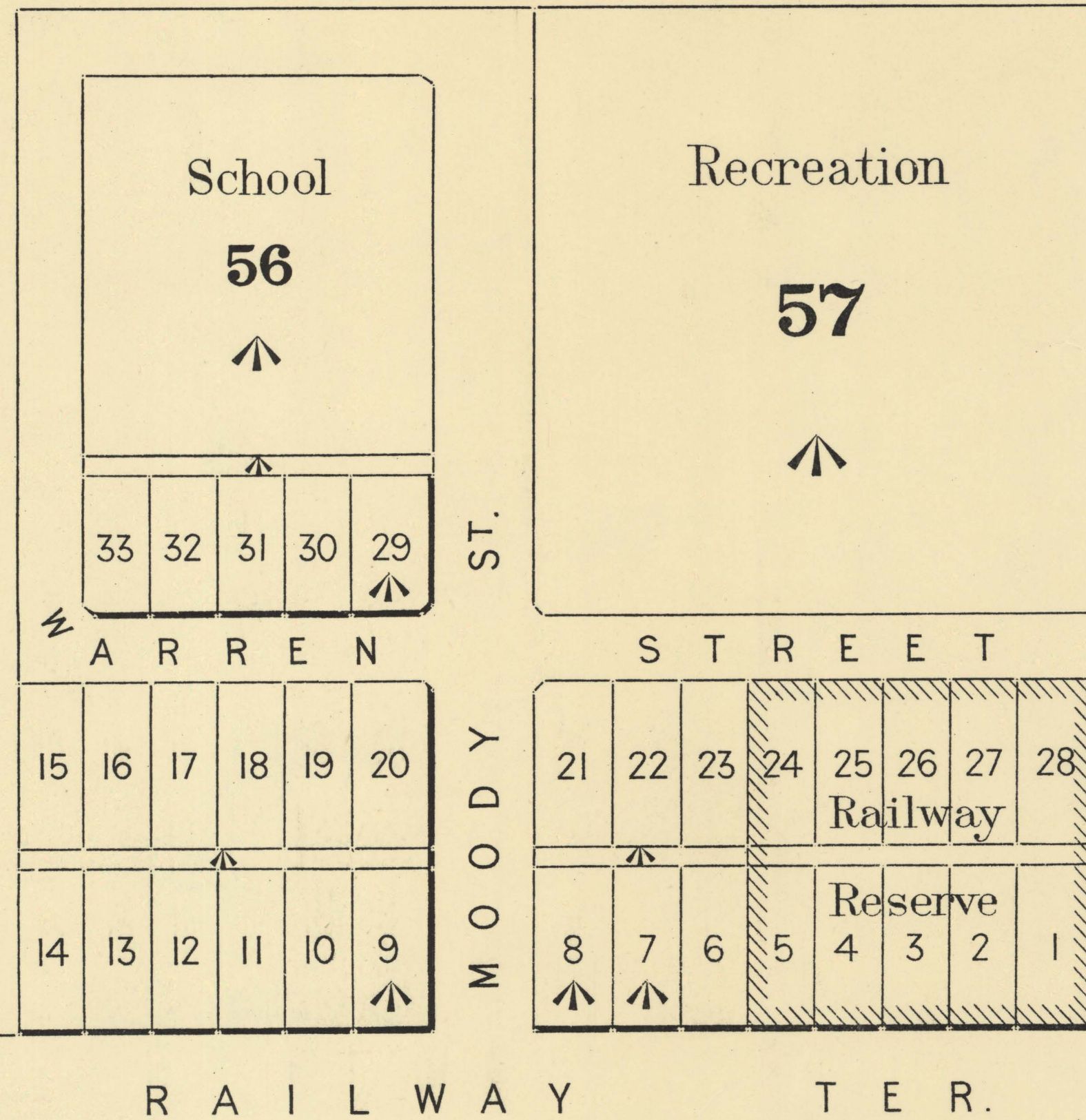

12

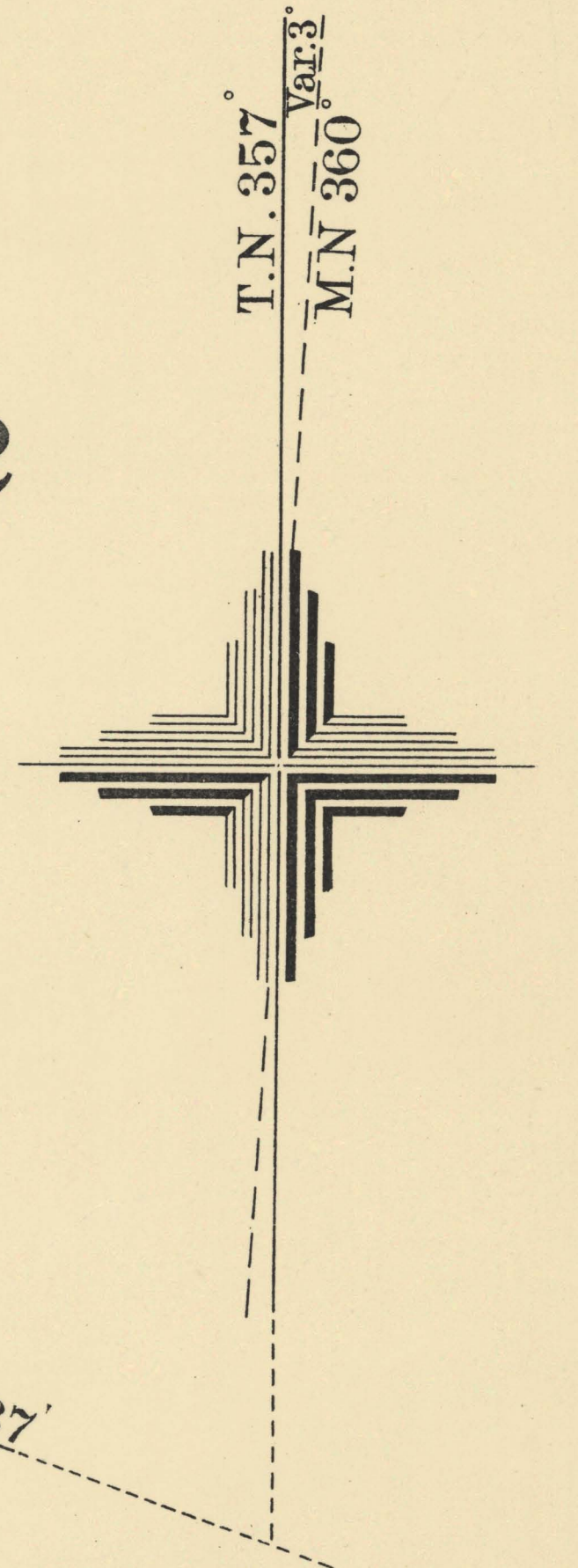

EAST TER.

107° 37'

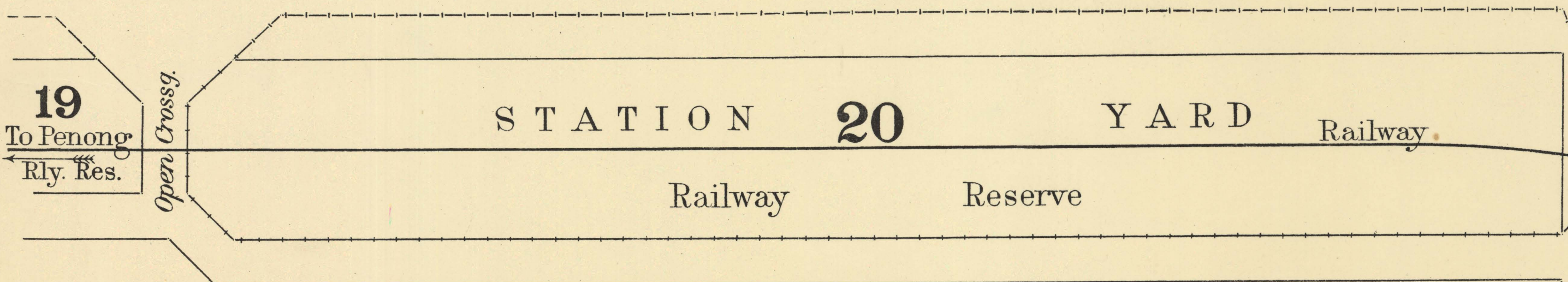

19
To Penong
Rly. Res.

Open Crossg.

Open Crossg.

17

To Theyenard
Rly. Res.

3

15

Note. The Government retains the right to extend this town at any time and in any direction.

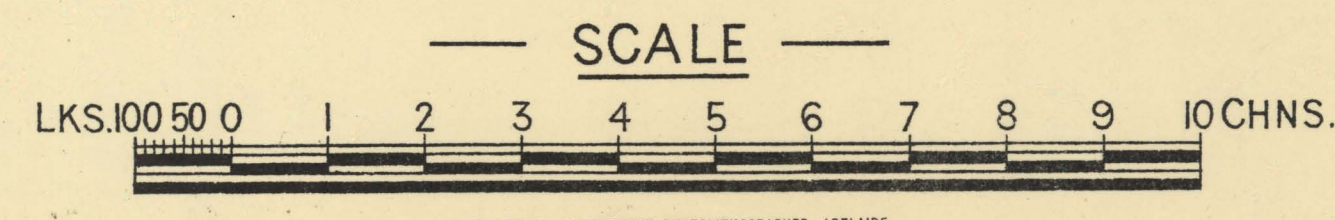

COMPILED UNDER THE DIRECTION OF THEO. E. DAY, SURVEYOR GENERAL.

H. E. POWELL, GOVERNMENT PHOTOLITHOGRAPHER, ADELAIDE.