

# YATALA CO. ADELAIDE

H 830 bje  
1:63,660  
Yatala  
1962

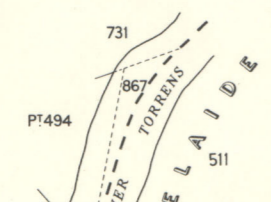

## ENLARGEMENTS

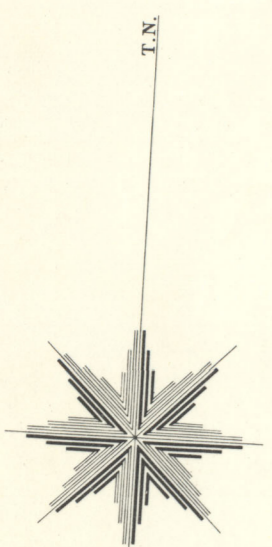
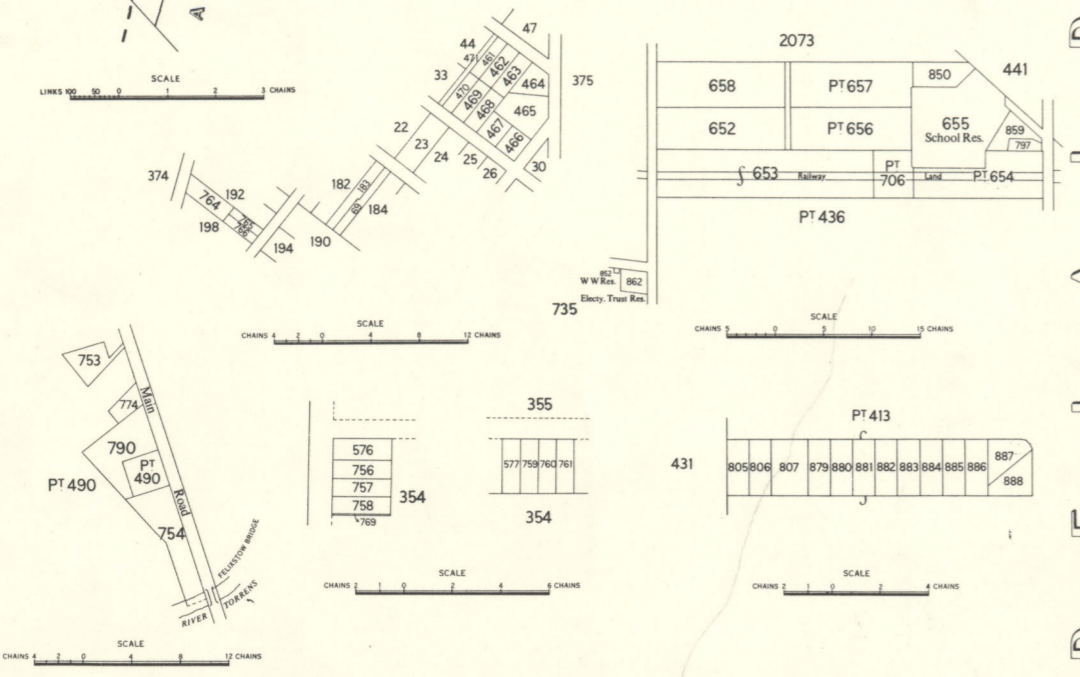

The whole of sections 1, 11/14 and closed road adjoining, and part of sections 68, 73/5, 82/4, 89/9, 94, 103/7 and 925 are Harbours Board Land.

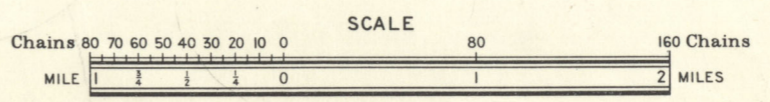
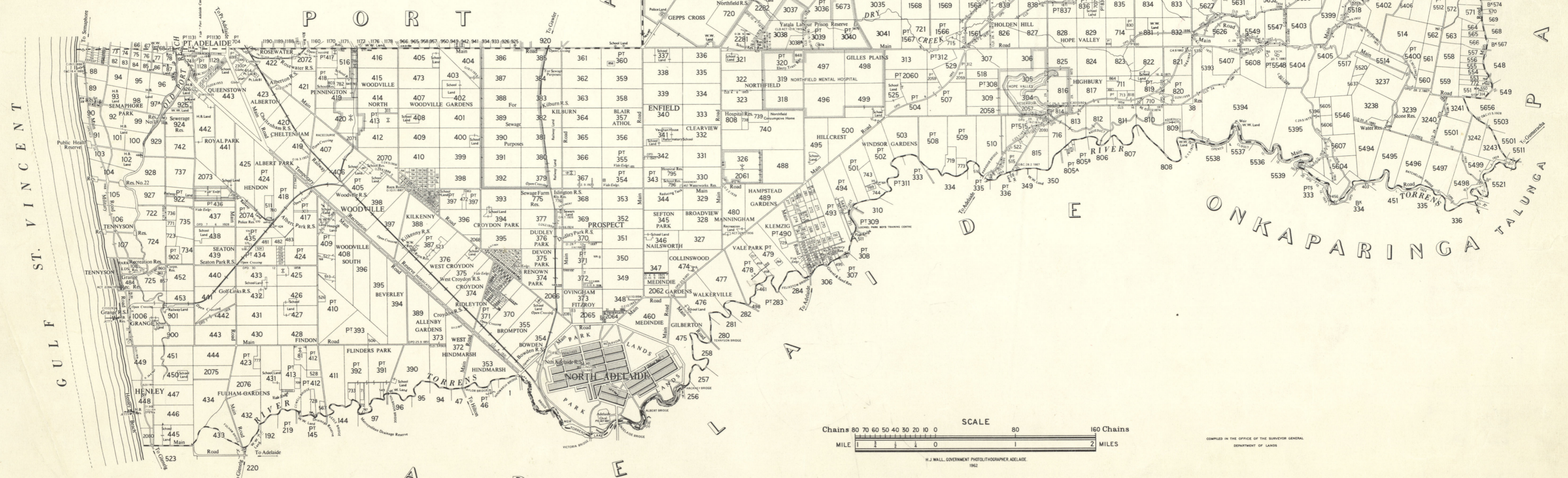

COMPILED IN THE OFFICE OF THE SURVEYOR GENERAL  
DEPARTMENT OF LANDS

H. J. WALL, GOVERNMENT PHOTO-LITHOGRAPHER, ADELAIDE, 1962

YATALA