

# YACKAMoorUNDIE C<sup>o</sup> STANLEY

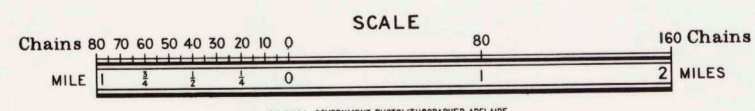

H.J. WALL, GOVERNMENT PHOTOLITHOGRAPHER, ADELAIDE, 1907

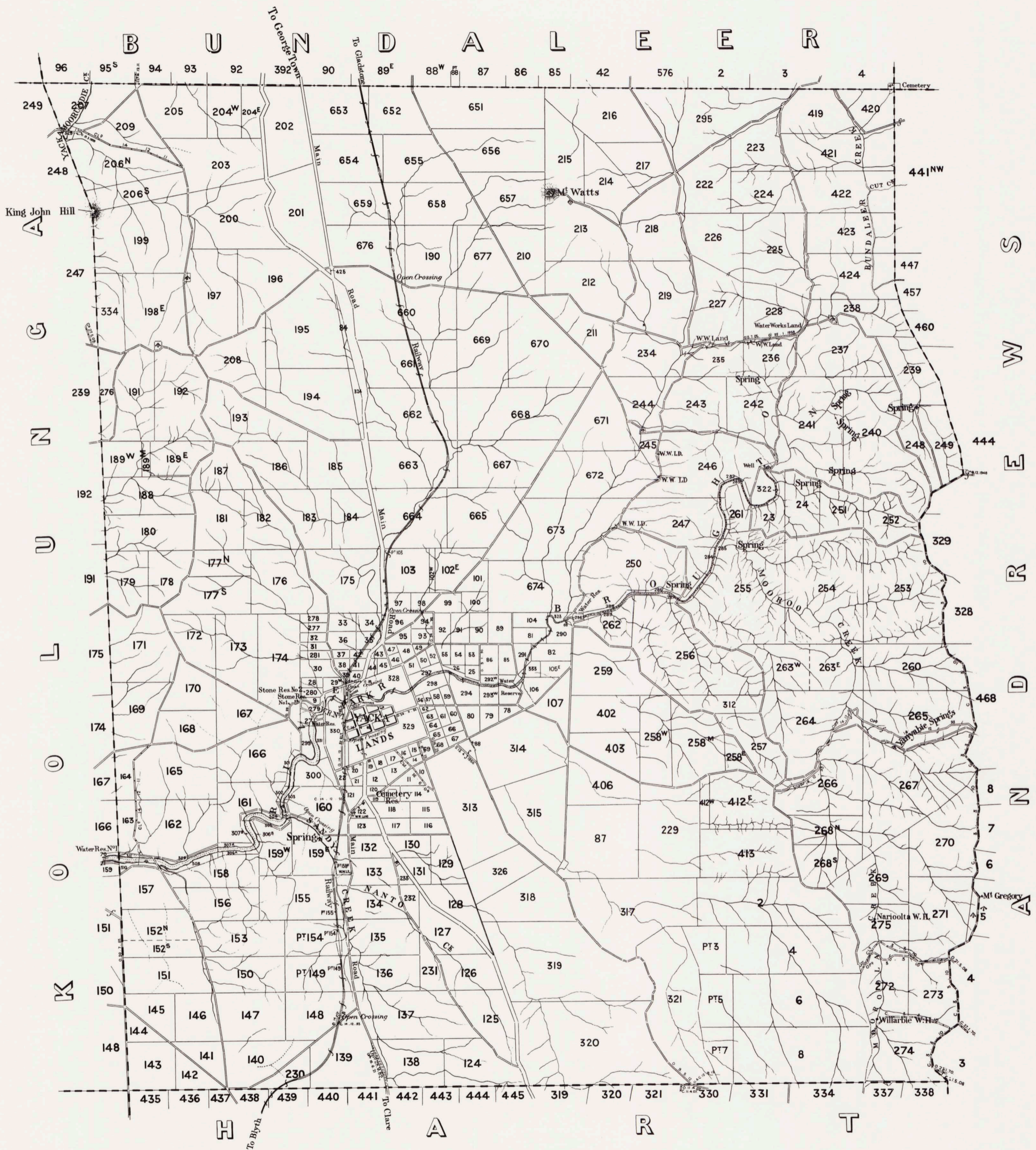

COMPILED IN THE OFFICE OF THE SURVEYOR GENERAL, DEPARTMENT OF LANDS

AS TO BE  
CORRECTED  
2d p. p. p. p.

YACKAMoorUNDIE 1907