

NICHOLLS

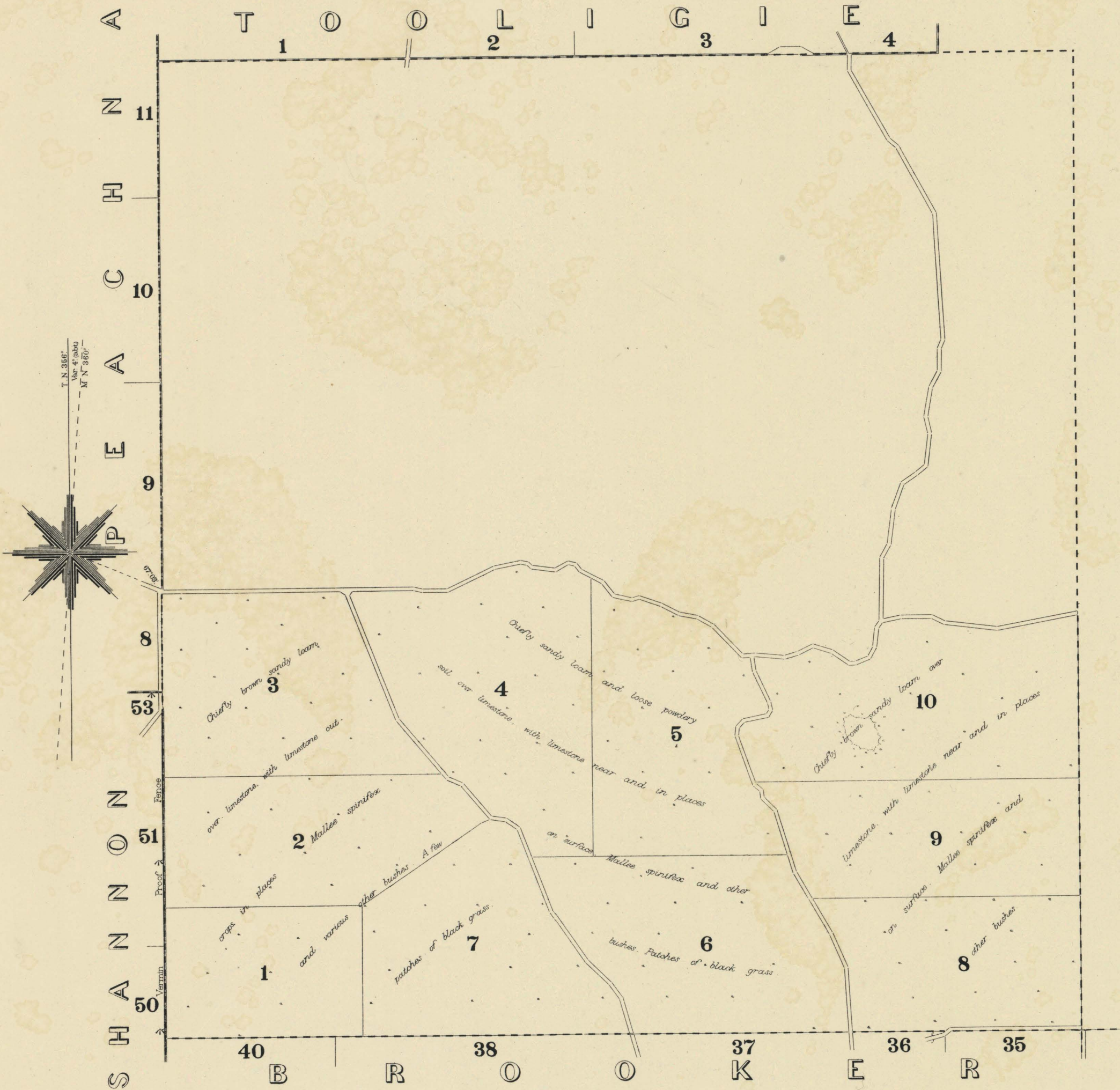

COMPILED IN THE OFFICE OF THE SURVEYOR-GENERAL.
DEPARTMENT OF LANDS AND SURVEY

H. E. POWELL, GOVERNMENT PHOTOLITHOGRAPHER, ADELAIDE.
1930

H
830 bje
1:63,360
Nicholls
1930

Nicholls