

GREGORY

*connecting ab6 & ab4
all assessed at £1.10 per acre
ab6 } £2.
ab4 }*

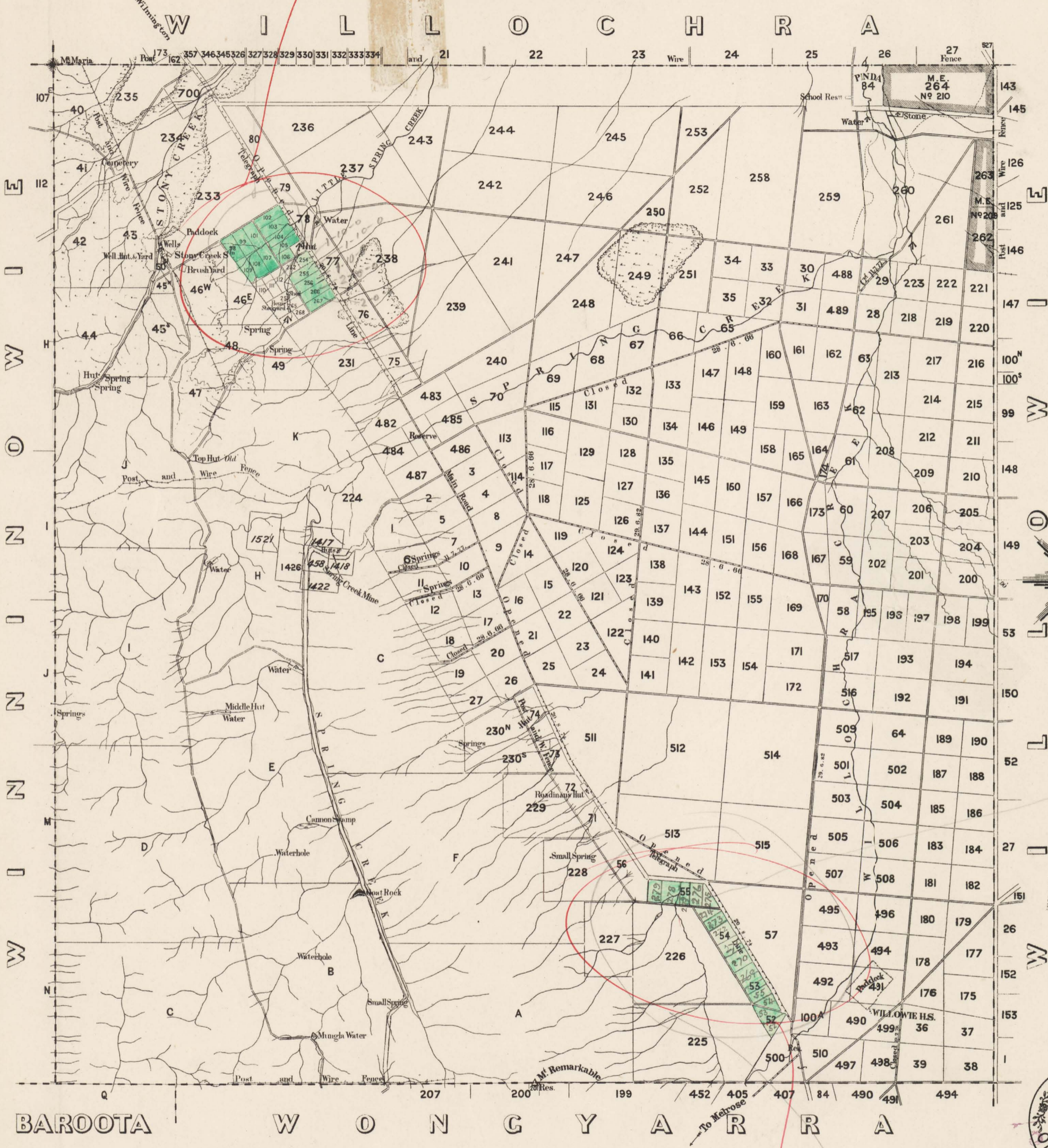

—SCALE—
Chains 80 70 60 50 40 30 20 10 0 80 160
Miles
(5978)
SURVEYOR GENERAL'S OFFICE, ADELAIDE, Fraser S. Crawford, Photolithographer.
SEPTEMBER 1886

£1. per acre

GREGORY