

106
104
96 97

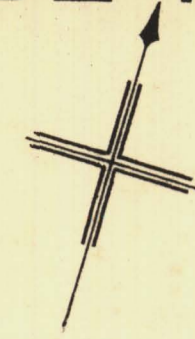

P A R K L A N D S

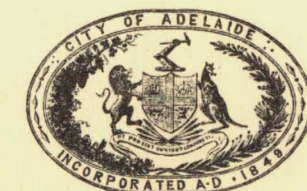
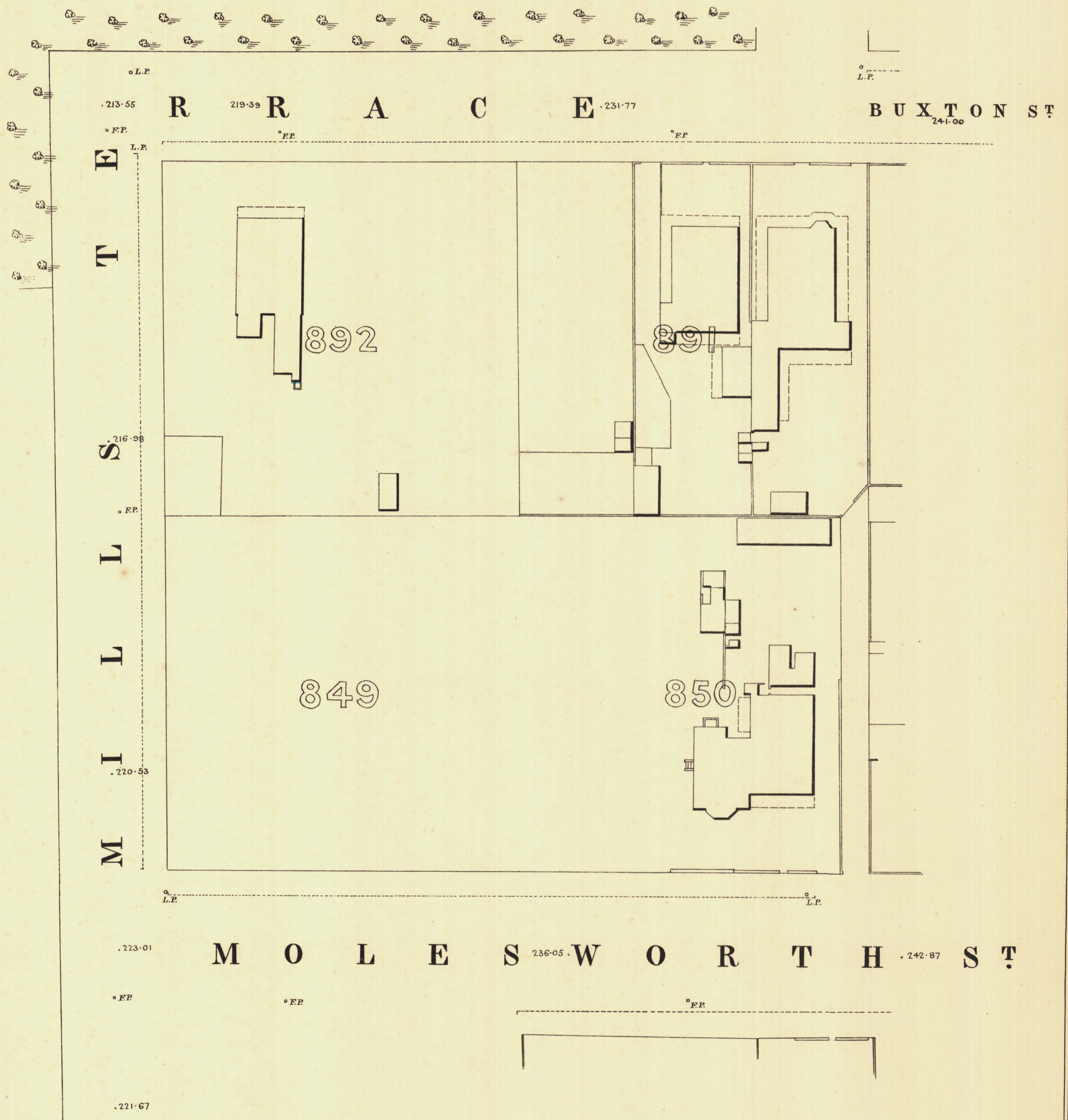

T. Smith
Mayor

Thomas Worth
Town Clerk

Scale Forty Feet to One Inch
0 50 100 200 300 Feet.

SURVEYOR GENERAL'S OFFICE, ADELAIDE. Paper S. Greenfield. Photo-lithography.

REFERENCE

Town Acres shown thus - [Symbol]	Fire Plugs shown thus - [Symbol]
Stone Buildings - [Symbol]	Stop-cocks - [Symbol]
Brick do - [Symbol]	Stand pipes - [Symbol]
Wood and Iron do - [Symbol]	Lamp-posts - [Symbol]
Public Post-offices - [Symbol]	Telegraph-posts - [Symbol]
Levels - [Symbol]	Datum 100 Feet below Low-water at Port Adelaide.

Charles W. Smith
City Engineer
Licensed Surveyor R.F.A.