

NORTH ADELAIDE

Sheet N° 84.

MAC DONNELL WARD

KEY TO ADJOINING SHEETS

86 85
83

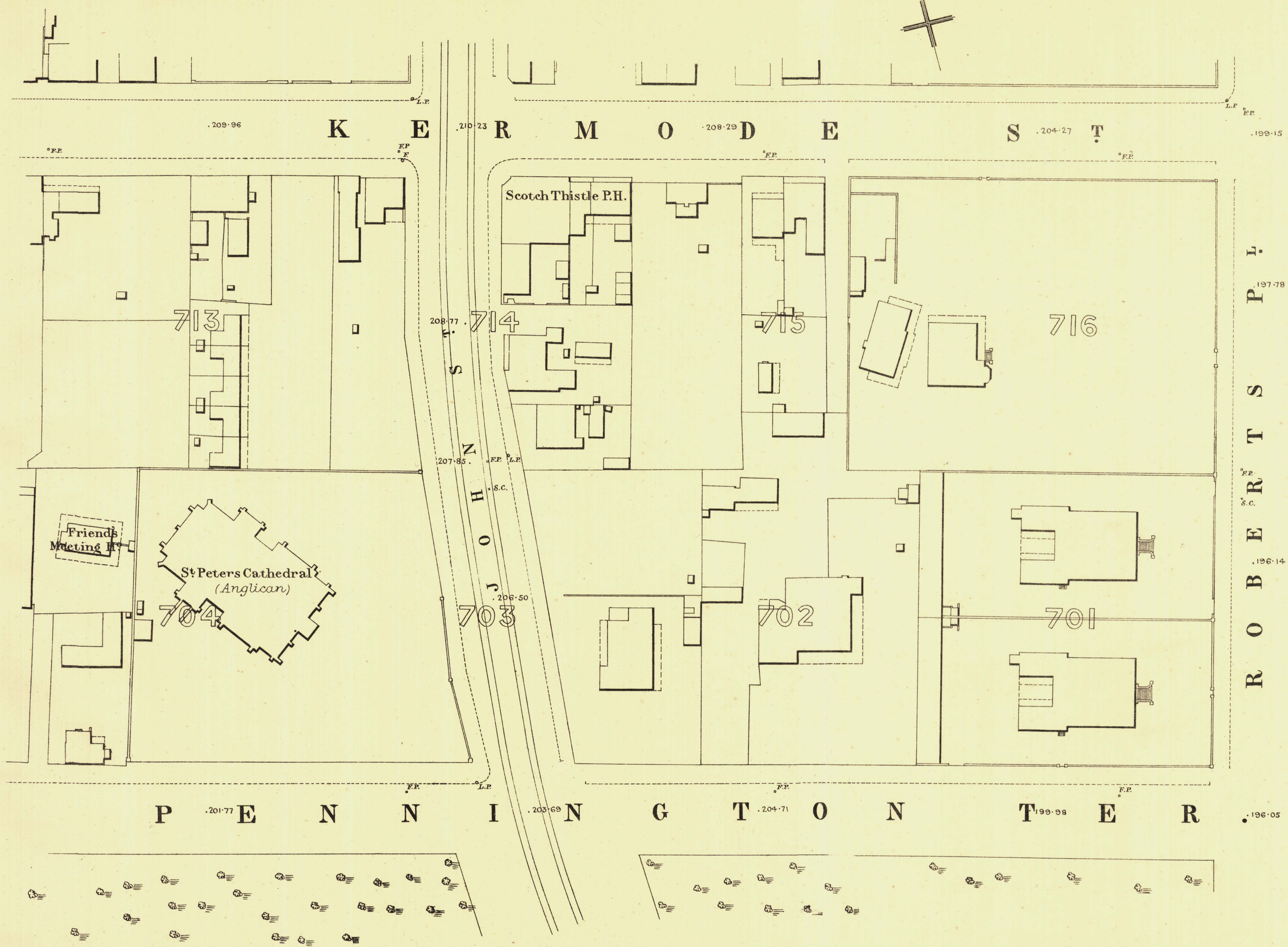
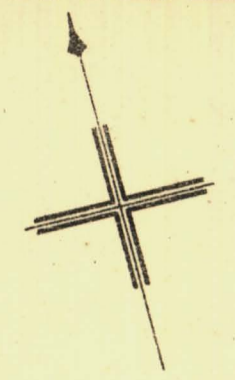

T. Smith
Mayor

Thomas Wortrup
Town Clerk

Scale Forty Feet to One Inch
100 200 300 Feet.

SURVEYOR GENERAL'S OFFICE, ADELAIDE. Printer: S. Greenfield, Photo-lithographer.

REFERENCE

Town Acres shown thus	141	Fire Plugs shown thus	o.F.P.
Stone Buildings	—	Stop-cocks	*S.C.
Brick do	—	Stand-pipes	o.S.P.
Wood and Iron do	—	Lamp-posts	o.L.P.
Pillar Post-offices	o.P.O.	Telegraph posts	o.T.P.
Levels	229-31	Datum 100 Feet below Low water at Port Adelaide.	

Charles W. Smith
City Engineer
Licensed Surveyor R.F.A.