

SOUTH ADELAIDE

Sheet N^o 75.

HINDMARSH WARD

KEY TO ADJOINING SHEETS

| | |
|----|-------|
| 77 | 76 |
| 72 | 73 74 |
| 68 | 62 61 |

236-17

N

O

R

T

H

233-44

T

E

R

A

233-70

C

E

232-85

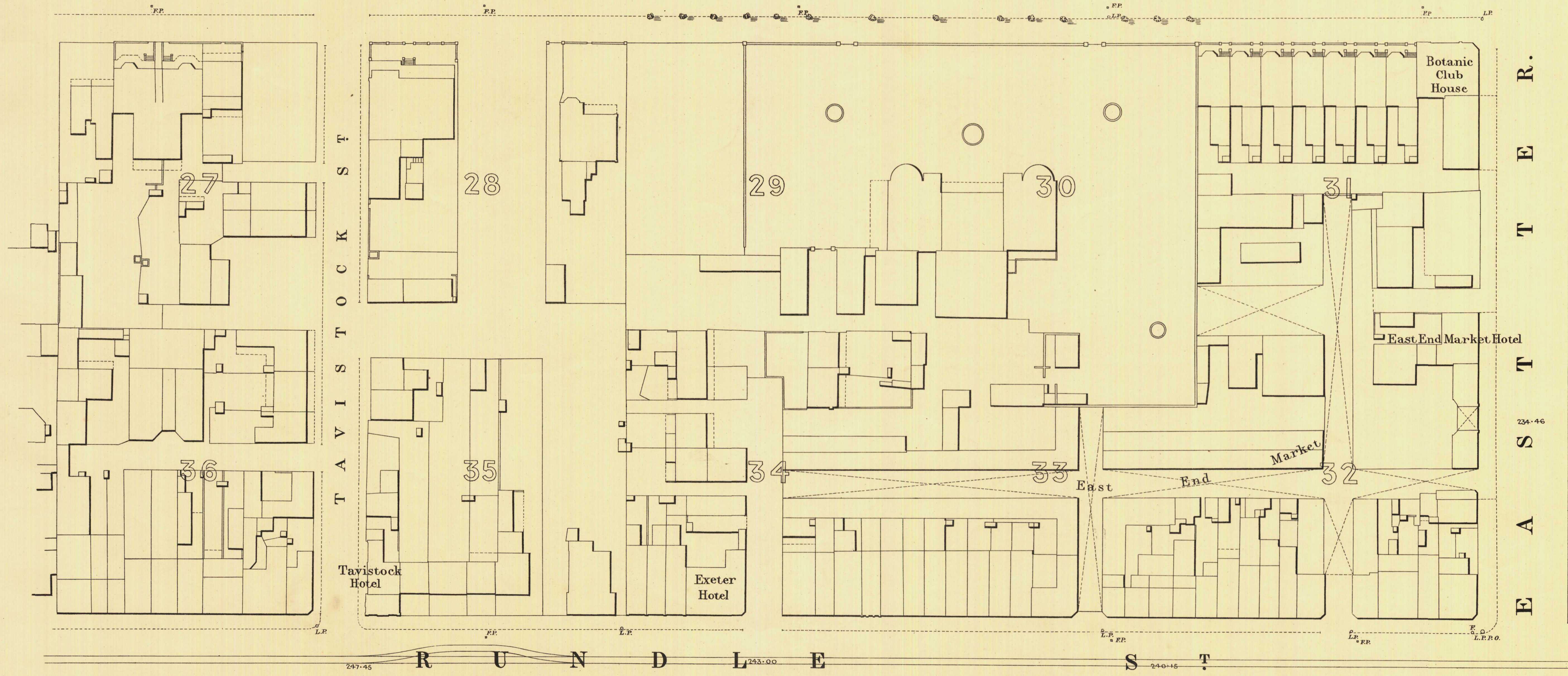

249-65

247-45

R

U

N

D

L

243-00

E

S

240-15

T

236-62

P



L. Smith
Mayor

Thomas Horwood
Town Clerk

100 Feet 50 0 200 300 Feet
Scale Forty Feet to One Inch = $\frac{1}{480}$

REFERENCE

| | | |
|----------------------------------|---|------|
| Town Acres shown thus - [Symbol] | Fire Plugs shown thus - [Symbol] | FP |
| Stone Buildings - [Symbol] | Stop-cocks - [Symbol] | S.C. |
| Brick do - [Symbol] | Stand pipes - [Symbol] | S.P. |
| Wood and Iron do - [Symbol] | Lamp posts - [Symbol] | L.P. |
| Pillar Post-offices - [Symbol] | Telegraph posts - [Symbol] | T.P. |
| Levels - [Symbol] | 229-31 Datum 100 Feet below Low-water at Port Adelaide. | |

Charles W. Smith
City Engineer
Licensed Surveyor R.F.A.