

SOUTH ADELAIDE

Sheet N^o 74

HINDMARSH WARD

KEY TO ADJOINING SHEETS

77	76	75
72	73	74
63	62	61

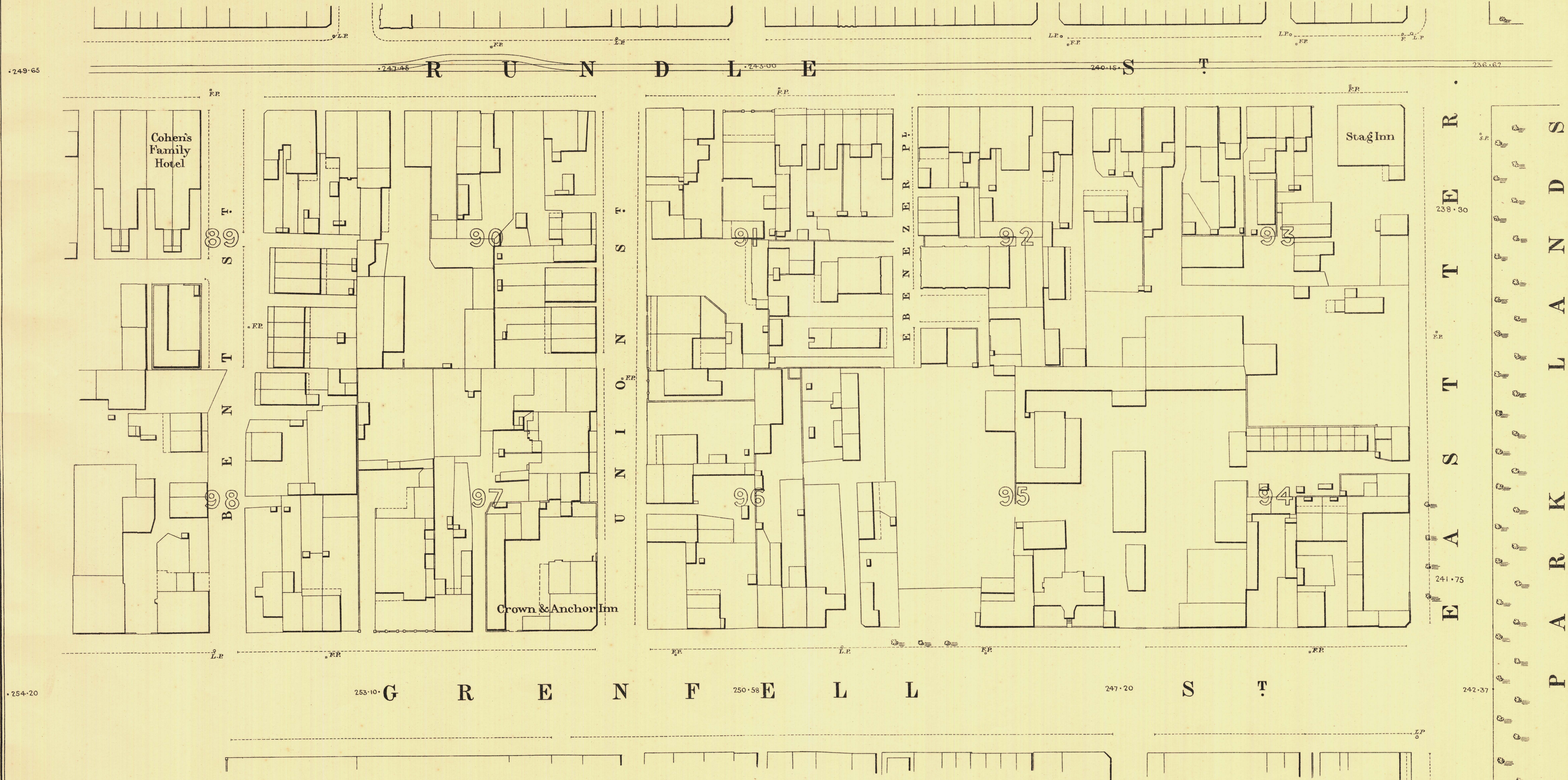
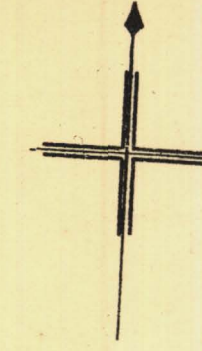

249.65

236.67

254.20

242.37



L. Smith Mayor

Thomas Brown Town Clerk

Scale Forty Feet to One Inch
100 Feet 50 200 300 Feet.

SURVEYOR GENERAL'S OFFICE, ADELAIDE. From S. Quarter, Photolithograph

REFERENCE

Town Acres shown thus	1/4	Fire Plugs shown thus	FP
Stone Buildings	[Symbol]	Stop-cocks	S.C.
Brick do	[Symbol]	Stand pipes	S.P.
Wood and Iron do	[Symbol]	Stamp posts	S.P.
Pillar Post offices	[Symbol]	Telegraph posts	T.P.
Levels	229.31	Datums 100 Feet below Low-water at Port Adelaide.	

Charles W. Smith
City Engineer
Licensed Surveyor R.P.A.