

SOUTH ADELAIDE

Sheet N<sup>o</sup> 70.

CAWLER WARD

KEY TO ADJOINING SHEETS

80	79	78
69	68	71
66	65	64

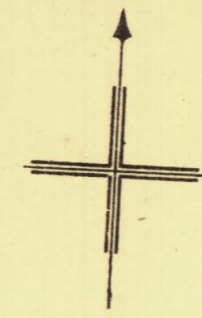

S  
T  
R  
E  
E  
T  
M  
O  
R  
P  
H  
E  
T

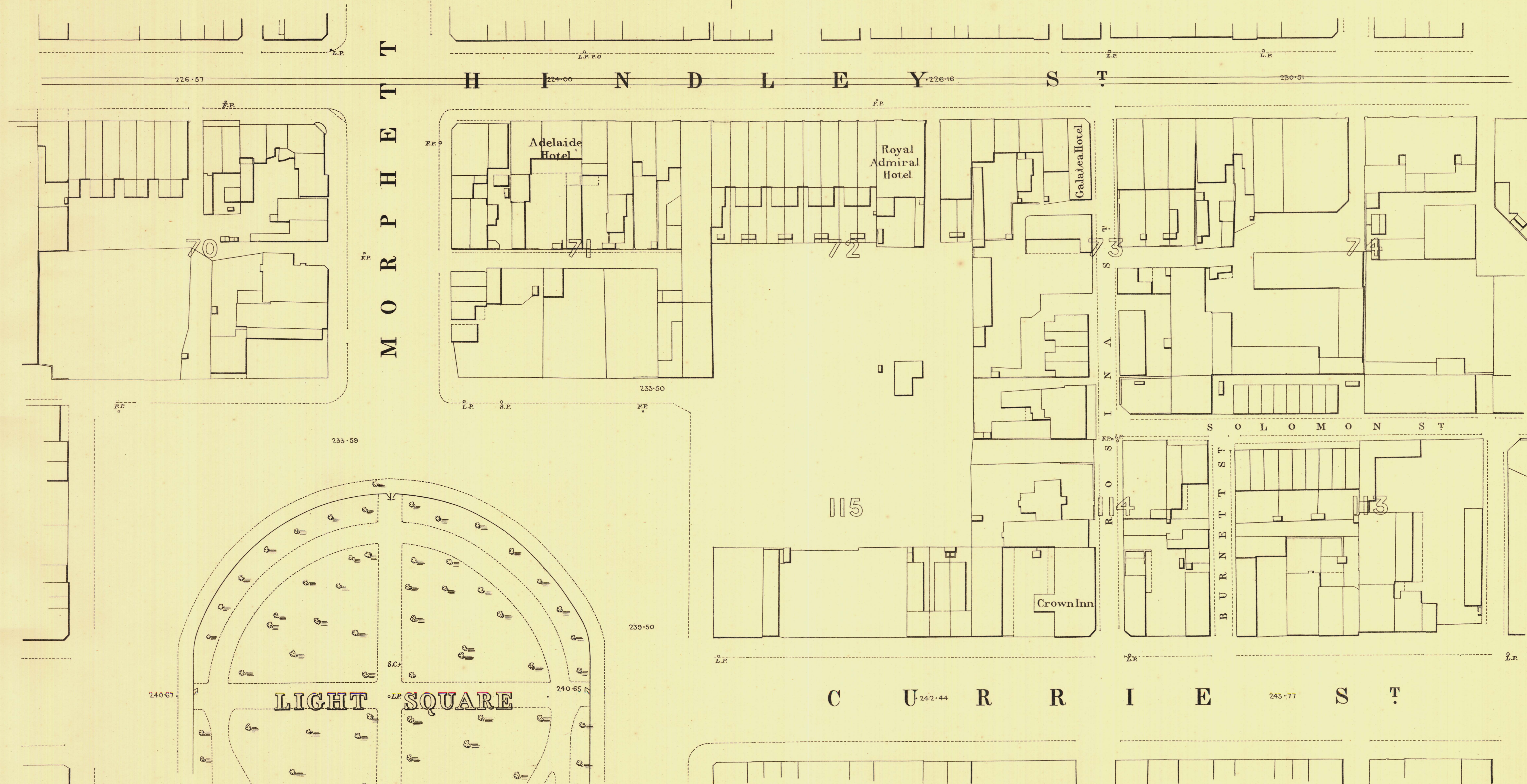

*L. Smith* Mayor

*Thomas W. Smith* Town Clerk

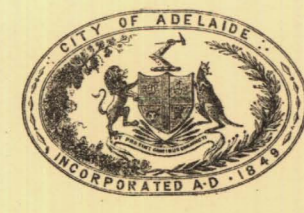

100 Feet 50 0 200 300 Feet

Scale Forty Feet to One Inch

SURVEYOR GENERAL'S OFFICE, ADELAIDE. From S. Oswald's Photolithograph.

REFERENCE

Town Acres shown thus -	1/4"	Fire Plugs shown thus -	o FP
Stone Buildings -	□	Stop-cocks -	* S.C.
Brick do -	▨	Stand-pipes -	o S.P.
Wood and Iron do -	▩	Lamp-posts -	o L.P.
Pillar Post-offices -	o P.O.	Telegraph-posts -	o T.P.
Levels -	228-31	Datum 100 Feet below Low-water at Port Adelaide.	

*Charles W. Smith*  
City Engineer  
Licensed Surveyor R.P.A.