

SOUTH ADELAIDE

Sheet N^o 66.

CAWLER WARD

KEY TO ADJOINING SHEETS

68	69	70
67	66	65
52	54	55

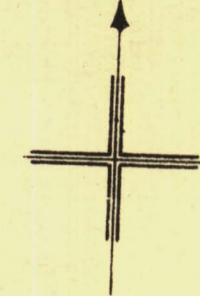

240-82

C U R R I E S T R E E T

240-67

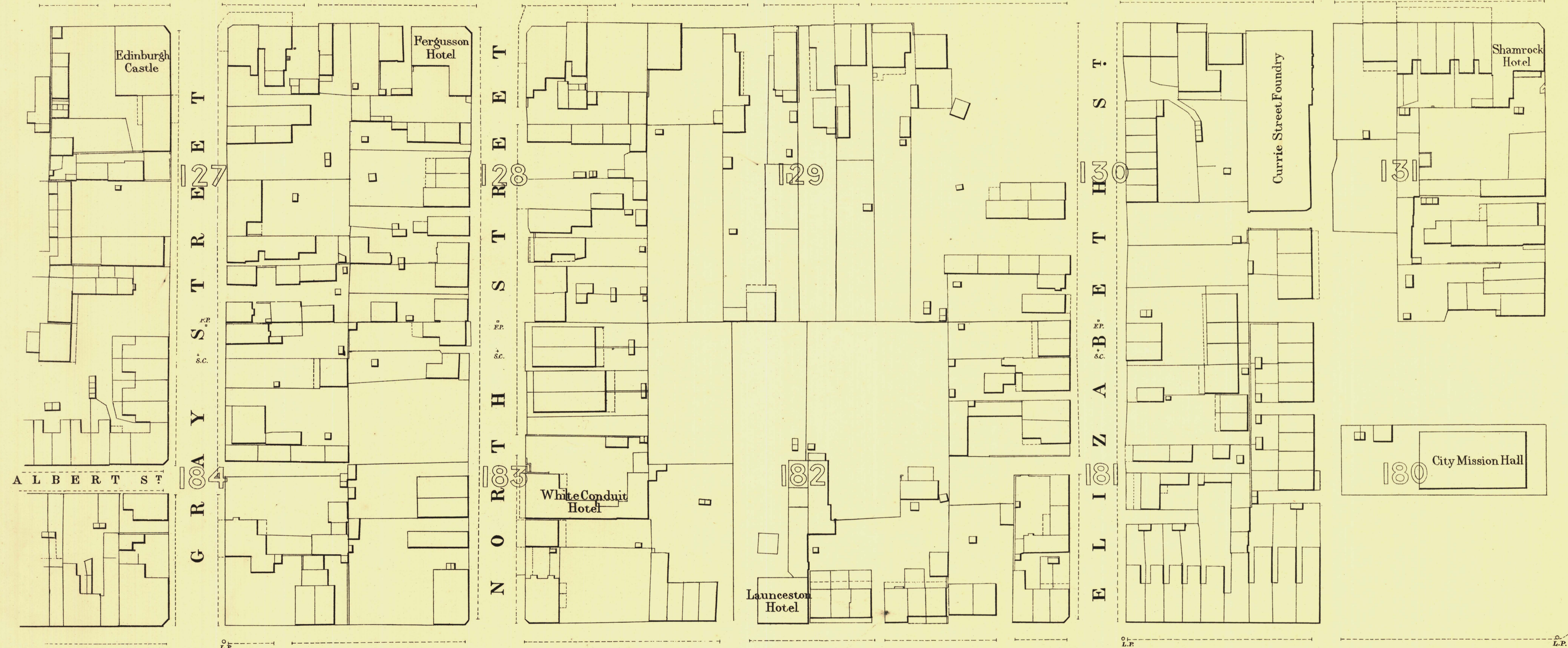

241-22

W A Y M O U T H S T R E E T

245-13



T. Smith
Mayor

Thomas Wortrup
Town Clerk

100 Feet 50 0 200 300 Feet

Scale Forty Feet to One Inch

SURVEYOR GENERAL'S OFFICE, ADELAIDE. Drawn by E. Owen. Photo-lithographed.

REFERENCE

Town Acres shown thus	[Symbol]	Fire Flights shown thus	[Symbol]
Stone Buildings	[Symbol]	Stop-cocks	[Symbol]
Brick do	[Symbol]	Stand-pipes	[Symbol]
Wood and Iron do	[Symbol]	Lamp-posts	[Symbol]
Pillar Post-offices	[Symbol]	Telegraph-posts	[Symbol]
Levels	[Symbol]	Datum, 100 Feet below Low water at Port Adelaide.	[Symbol]

Walter W. Smith
City Engineer

Licensed Surveyor R.P.A.