

SOUTH ADELAIDE

Sheet No 63

HINDMARSH WARD

KEY TO ADJOINING SHEETS

71	72	73
64	62	
56	57	58

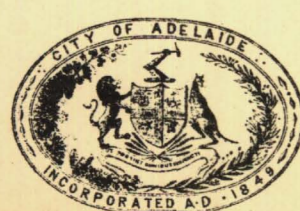
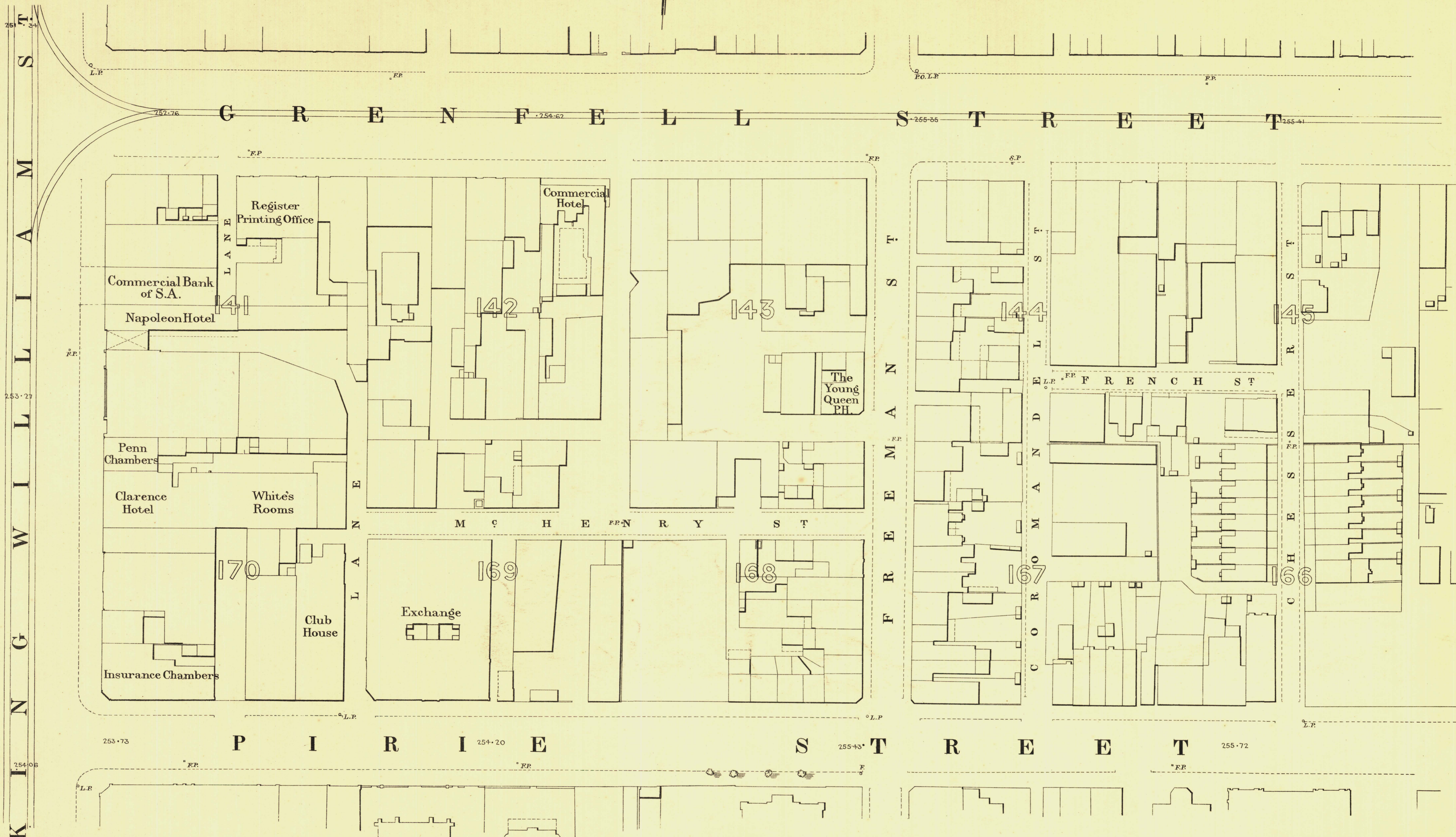
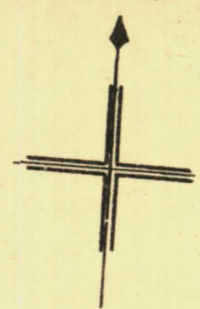

*L. Smith* Mayor  
*Thomas W. Smith* Town Clerk

Scale Forty Feet to One Inch =  $\frac{1}{480}$   
 100 Feet 50 0 200 300 Feet

SURVEYOR GENERAL'S OFFICE, ADELAIDE. Drawn S. Greenfield, Photo-lithographer.

REFERENCE

Town Acres shown thus - 141	Fire Plugs shown thus - o.P.P.
Stone Buildings - [Symbol]	Stop-cocks - s.c.
Brick do - [Symbol]	Stand pipes - s.P.
Wood and Iron do - [Symbol]	Lamp posts - L.P.
Pillar Post-offices - o.P.O.	Telegraph posts - T.P.
Levels - 229-31	Datum 100 Feet below Low Water at Port Adelaide.

*Charles W. Smith*  
 City Engineer  
 Licensed Surveyor R.P.A.