

SOUTH ADELAIDE

Sheet N^o 38.

GREY WARD

KEY TO ADJOINING SHEETS

52	51	50
37		39
36	35	34

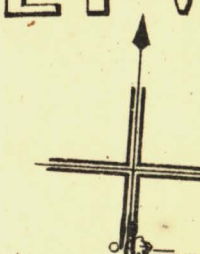

G R O T 242-35 E S T 243-08 R E E T 244-37

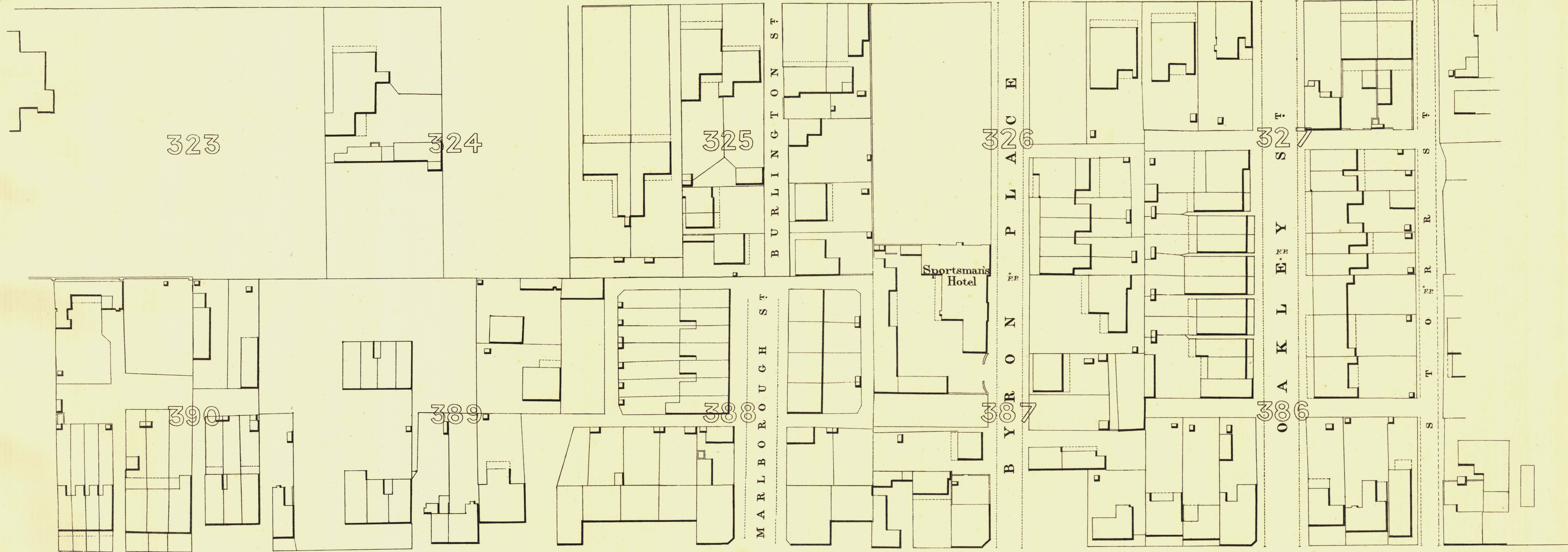

Sportsman's Hotel

G 240-18 O U G E R 241-43 S 242-64 T

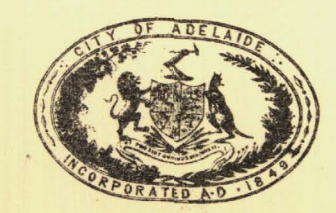

T. Smith
Mayor

Thomas W. Smith
Town Clerk

Scale Forty Feet to One Inch
100 Feet 50 0 200 300 Feet

SURVEYOR GENERAL'S OFFICE, ADELAIDE. From S. Crawford's Photolithograph

REFERENCE

Town Acres shown thus	[4]	Fire Plugs shown thus	□FP
Stone Buildings	[shaded]	Stop-cocks	*S.C.
Brick do	[hatched]	Stand-pipes	□S.P.
Wood and Iron do	[cross-hatched]	Lamp-posts	○L.P.
Pillar Post-offices	○P.O.	Telegraph-posts	□T.P.
Levels	229-31	Datum 100 Feet below Low-water at Port Adelaide.	

Charles W. Smith
City Engineer
Licensed Surveyor R.P.A.