

SOUTH ADELAIDE

Sheet No 23.

YOUNG WARD

KEY TO ADJOINING SHEETS

35	32	31
22	23	24
15	14	13

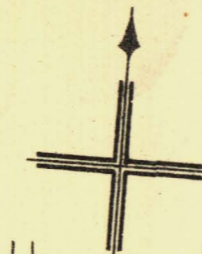

CARRINGTON 253-06 252-16 252-55

KING WILLIAM STREET

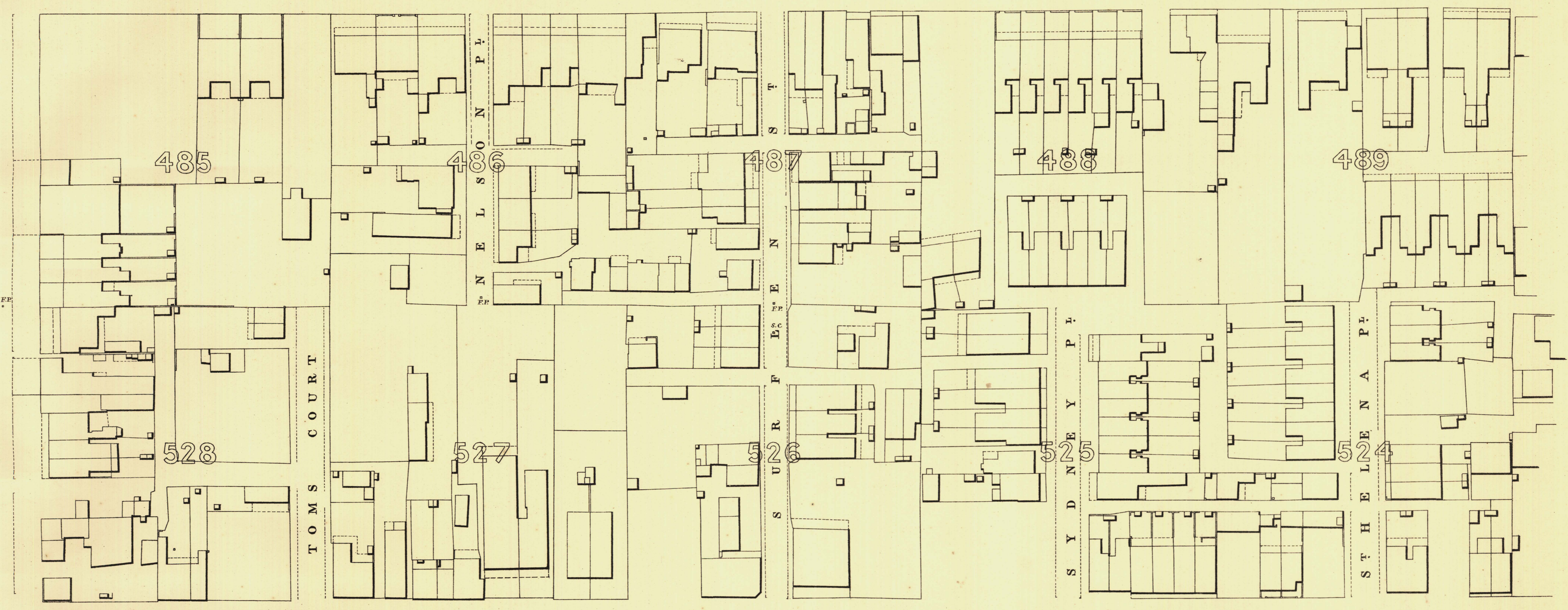

HALIFAX 252-12 250-55 250-97 251-45

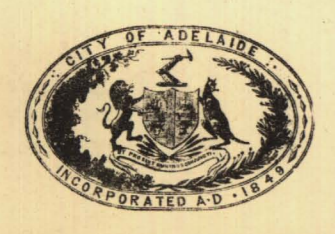

L. Smith Mayor

Thomas Hornsby Town Clerk

100 Feet 50 0 200 300 Feet

Scale Forty Feet to One Inch
SURVEYOR GENERAL'S OFFICE, ADELAIDE. Drawn & Engraved by Photo-lithography

REFERENCE

Town Acres shown thus - [diagonal lines]	Fire Plugs shown thus - [circle with cross]	FP
Stone Buildings - [solid black]	Stop-cocks - [circle with dot]	SC
Brick do - [stippled]	Stand-pipes - [circle with cross]	SP
Wood and Iron do - [cross-hatched]	Lamp-posts - [circle with cross]	LP
Pillar Post-offices - [circle with cross]	Telegraph-posts - [circle with cross]	TP
Levels - [dashed line]	229-31 Datum 100 Feet below Low-water at Port Adelaide.	

Charles W. Smith
City Engineer
Licensed Surveyor R.P.A.