

SOUTH ADELAIDE

GREY WARD

KEY TO ADJOINING SHEETS

Sheet No. 4.

21	22	23
16	15	14
3	5	

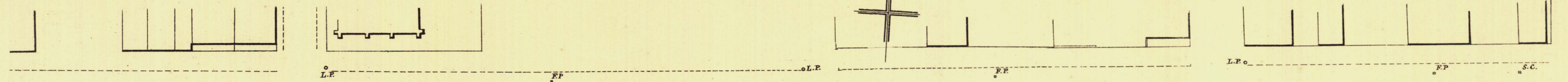

G I L B E R T S T R E E T

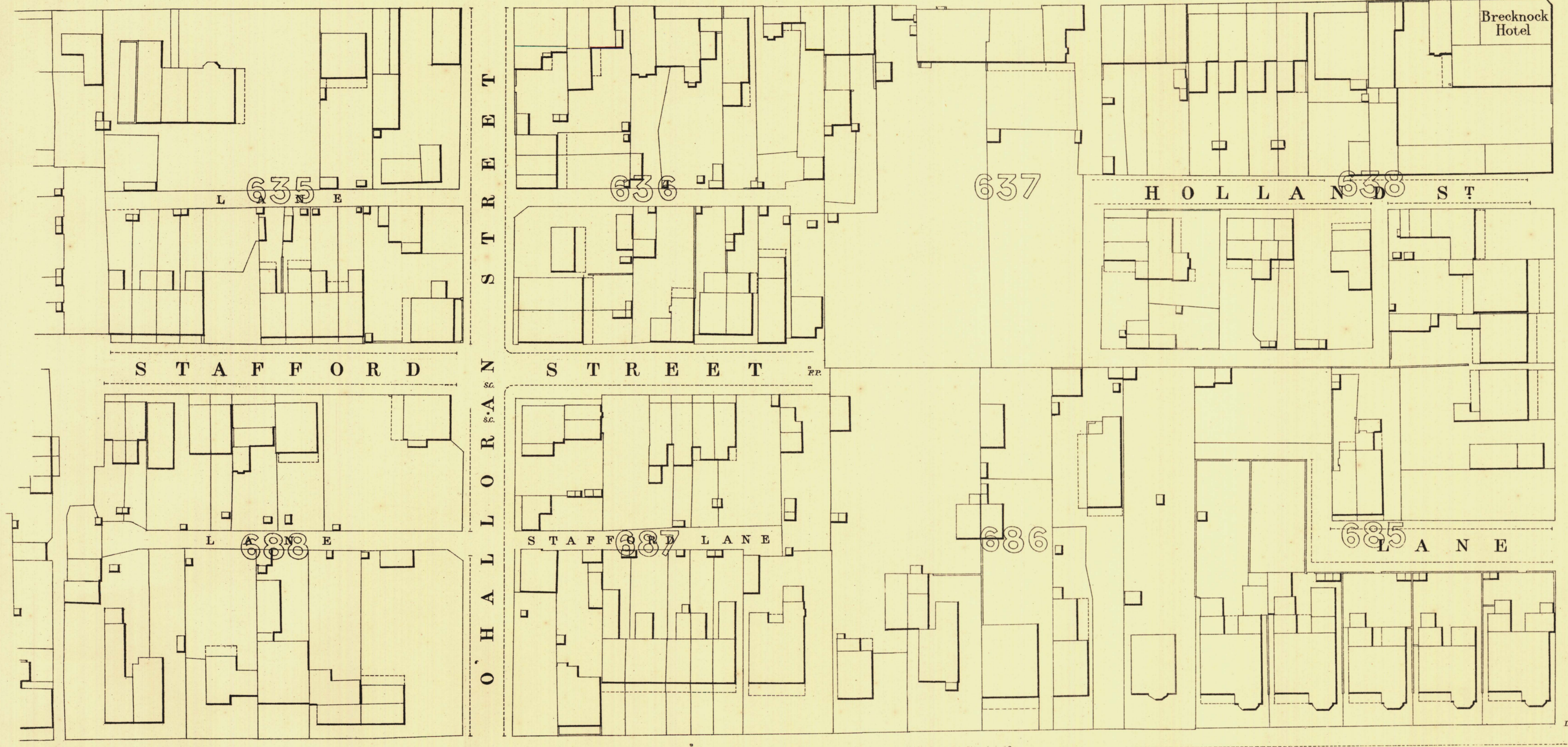

S O U T H T E R R A C E

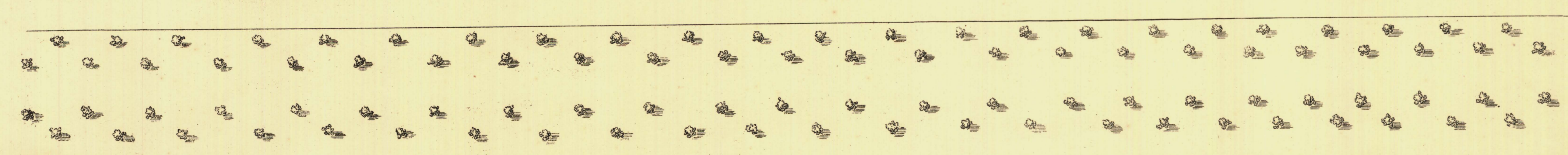

P A R K L A N D S

A & G. Railway

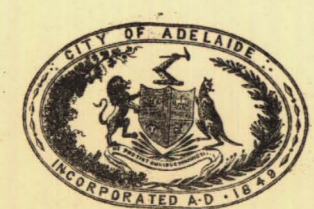

T. Smith Mayor

Thomas Horn Town Clerk

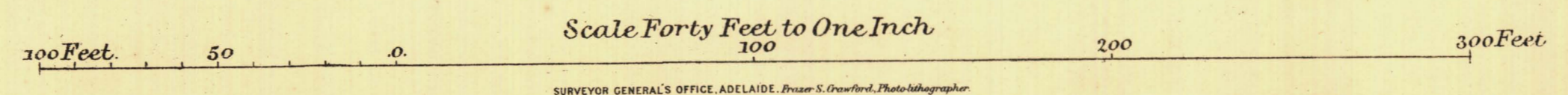

Scale Forty Feet to One Inch

SURVEYOR GENERAL'S OFFICE, ADELAIDE, Printer: S. Oswald, Photo-lithographer

REFERENCE

Town Areas shown thus	144	Fire Plugs shown thus	o.F.P.
Stone Buildings	—	Stop-cocks	o.S.C.
Brick do	—	Stand-pipes	o.S.P.
Wood and Iron do	—	Lamp-posts	o.L.P.
Pillar Post-offices	o.P.O.	Telegraph posts	o.T.P.
Levels	229.31	Datsum 100 Feet below Low-water at Port Adelaide.	

Charles W. Smith
City Engineer
Licensed Surveyor R.P.A.